



US Army Corps
of Engineers
Seattle District

Special Public Notice

Regulatory Branch
4725 E. Marginal Way S., Building 1202
Seattle, Washington 98134
Telephone (206) 764-3495
ATTN: Ryan Cochoit

Public Notice Date: January 3, 2024

ANNOUNCEMENT: Special processing procedures for NWS-2023-941-WRD; Marten Creek Bridge/Road Emergency Repair

BACKGROUND: Per 33 CFR 325.2(e)(4), Division engineers are authorized to approve special processing procedures in emergency situations. An “emergency” is a situation which would result in an unacceptable hazard to life, a significant loss of property, or an immediate, unforeseen, and significant economic hardship if corrective action requiring a permit is not undertaken within a time period less than the normal time needed to process the application under standard procedures. In emergency situations, the district engineer will explain the circumstances and recommend special procedures to the division engineer who will instruct the district engineer as to further processing of the application. Even in an emergency situation, reasonable efforts will be made to receive comments from interested Federal, state, and local agencies and the affected public. Also, notice of any special procedures authorized and their rationale is to be appropriately published as soon as practicable.

PURPOSE: The purpose of this Special Public Notice is to publish the special processing procedures undertaken for the above-referenced project.

EMERGENCY WORK: Repair 100 linear feet of the road prism, incorporating bank stabilization features beyond the existing road prism to accommodate recommendations from Tribal Fisheries staff to better reflect conditions present prior to construction of the Mountain Loop Highway. Up to 7,000 square feet of direct impacts are expected waterward of the OHWM. Fill within OHWM will include 4 to 6-man boulders (4,133 cubic yards over 2,000 square feet) and large woody debris (LWD) (2,000 cubic yards over 1500 square feet) would be installed as a buttress to support the slope toe. LWD placement below the OHWM will range from the thalweg to the toe of the slope. Approximately 9,000 CY of alluvial material will be excavated from the toe of the slope to facilitate installation of the logs and boulders. Riprap (370 cubic yards over 1,500 square feet) will be placed to shield the area above the boulder buttress. This riprap will be sloped at a 2:1 angle to ensure stability. Some LWD will be placed above the OHWM to build a shelf on which planting can occur to provide the slope additional stabilization. Underneath the riprap will be 1,765 cubic yards of 4 to 8-inch angular rock over 1,900 square feet. The remaining slope will be constructed of a geotextile layered wall topped with 2 to 3 feet of topsoil and then hydroseeded and planted with native vegetation. The exact planting schedule, including species and quantity, will be determined upon completion of the repair. The rocks,

boulders, and LWD are required to provide structural support and prevent further erosion of the slope into the water bodies, while the rip-rap and angular rocks/spalls serve as protective layers to reinforce the stabilized slope. Placement of LWD will also play a key element in slope stabilization. The emergency work is depicted on the enclosed drawings dated December 13, 2023.

DETERMINATION: The U.S. Army Corps of Engineers, Seattle District (Seattle District) determined the proposed emergency work met the above definition of an “emergency” and coordinated with the U.S. Army Corps of Engineers’ Northwestern Division (NWD) Commander for approval to implement special processing procedures. On December 26, 2023, the NWD Commander approved use of special processing procedures.

SPECIAL PROCESSING PROCEDURES: The Seattle District shall:

1. Ensure only the minimal amount of work is proposed to remedy the emergency.
2. Notify appropriate resource agencies and Tribes for their recommendations to minimize impacts to be considered for possible inclusion in the emergency authorization.
3. Special conditions can be added to the emergency authorization to ensure impacts are minimized.
4. After emergency authorization is granted, Seattle District will publish a public notice of these procedures.
5. Additional coordination with agencies and tribes may occur as necessary to complete certain processes after the emergency authorization is granted.

On December 26, 2023, emergency authorization was granted to the applicant. Publication of this public notice is part of the special processing procedures.



PURPOSE: CONCEPTUAL REPAIR OF FAILING EMBANKMENTS AT
CONFLUENCE OF MARTEN CREEK AND THE SOUTH FORK OF
STILLAGUAMISH RIVER.
DATUM: NAD83 AND NAVD88 OWNER: U.S. FOREST SERVICE
LOCATION: MP 20.6 MLH LAT: 48.071841° LONG: -121.606627°

MOUNTAIN LOOP HIGHWAY MP 20.6
EMERGENCY REPAIR PLAN VIEW
NWS-2023-941-WRD

APPLICATION BY: SNOHOMISH COUNTY PUBLIC WORKS
STATE: WASHINGTON
DATE: DECEMBER 13, 2023

SHEET
1
OF
6

Phase 04
0+00.00 TO 1+30.00

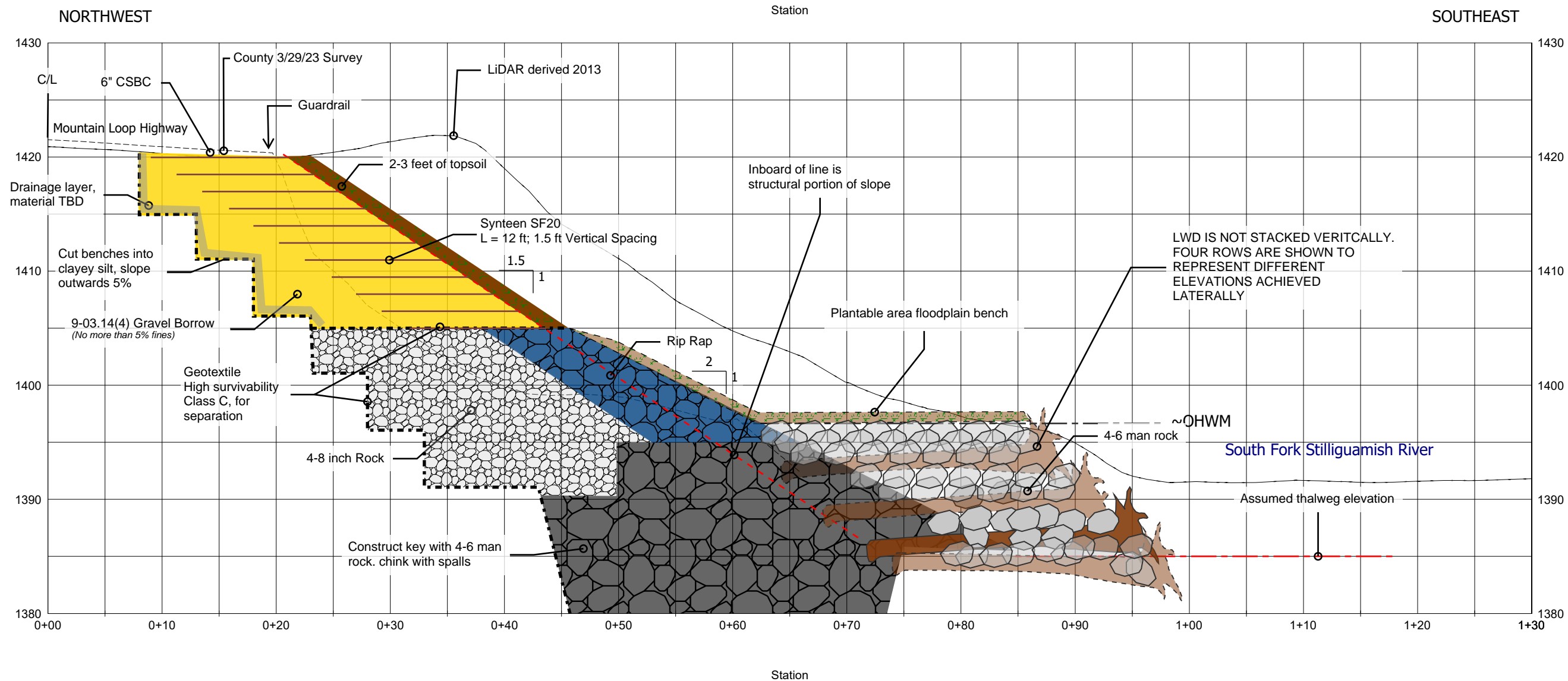

PURPOSE: CONCEPTUAL REPAIR OF FAILING EMBANKMENTS AT
CONFLUENCE OF MARTEN CREEK AND THE SOUTH FORK OF
STILLAGUAMISH RIVER.
DATUM: NAD83 AND NAVD88 OWNER: U.S. FOREST SERVICE
LOCATION: MP 20.6 MLH LAT: 48.071841° LONG: -121.606627°

NWS-2023-941-WRD
MOUNTAIN LOOP HIGHWAY MP 20.6
EMERGENCY REPAIR SF
STILLAGUAMISH RIVER SECTION

APPLICATION BY: SNOHOMISH COUNTY PUBLIC WORKS
STATE: WASHINGTON
DATE: DECEMBER 13, 2023

SHEET
4
OF
6

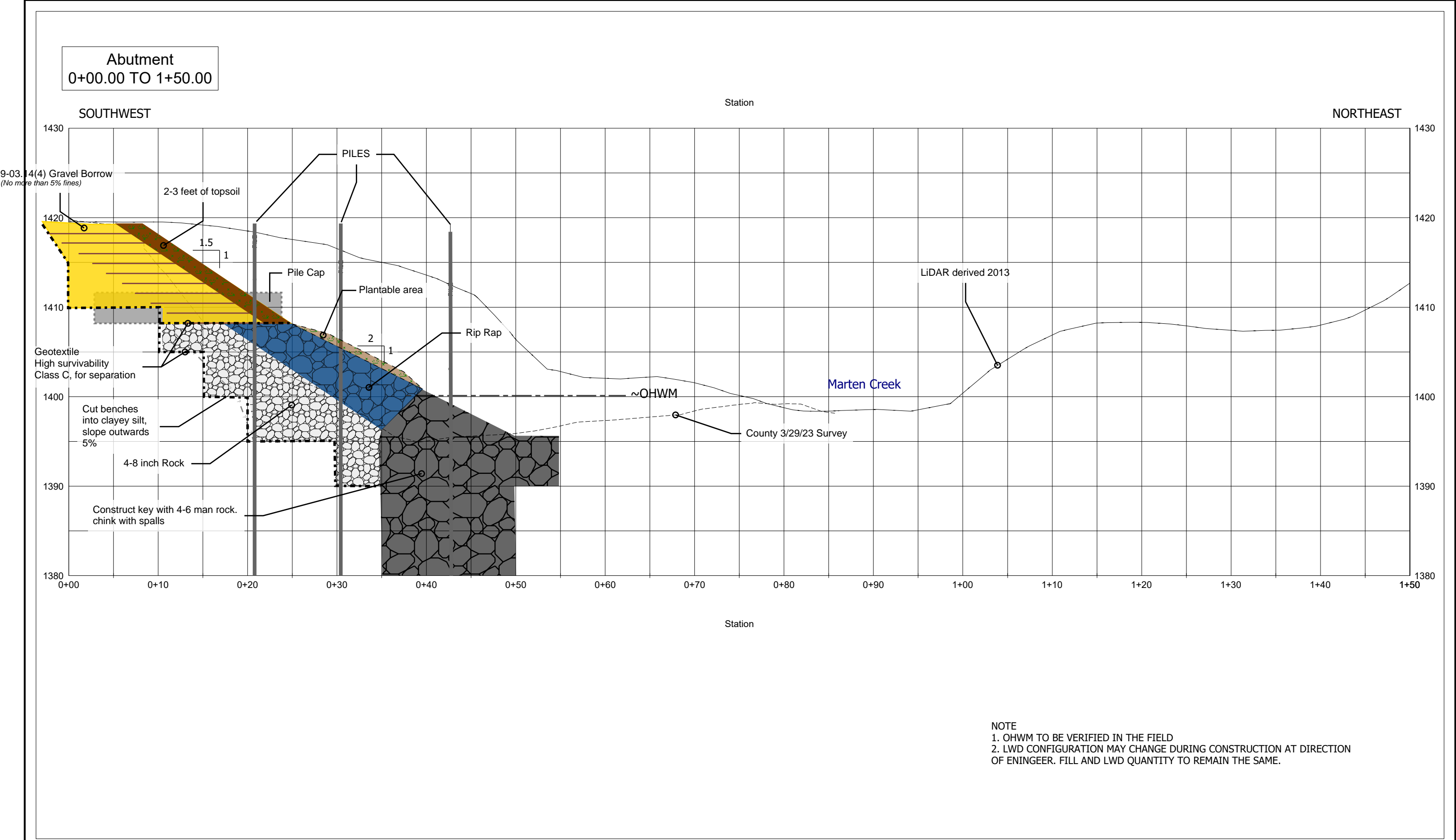

PURPOSE: CONCEPTUAL REPAIR OF FAILING EMBANKMENTS AT CONFLUENCE OF MARTEN CREEK AND THE SOUTH FORK OF STILLAGUAMISH RIVER.

DATUM: NAD83 AND NAVD88 OWNER: U.S. FOREST SERVICE

LOCATION: MP 20.6 MLH LAT: 48.071841° LONG: -121.606627°

NWS-2023-941-WRD
MOUNTAIN LOOP HIGHWAY MP 20.6
EMERGENCY REPAIR ABUTMENT
SECTION

APPLICATION BY: SNOHOMISH COUNTY PUBLIC WORKS
STATE: WASHINGTON
DATE: DECEMBER 13, 2023

SHEET
5
OF
6

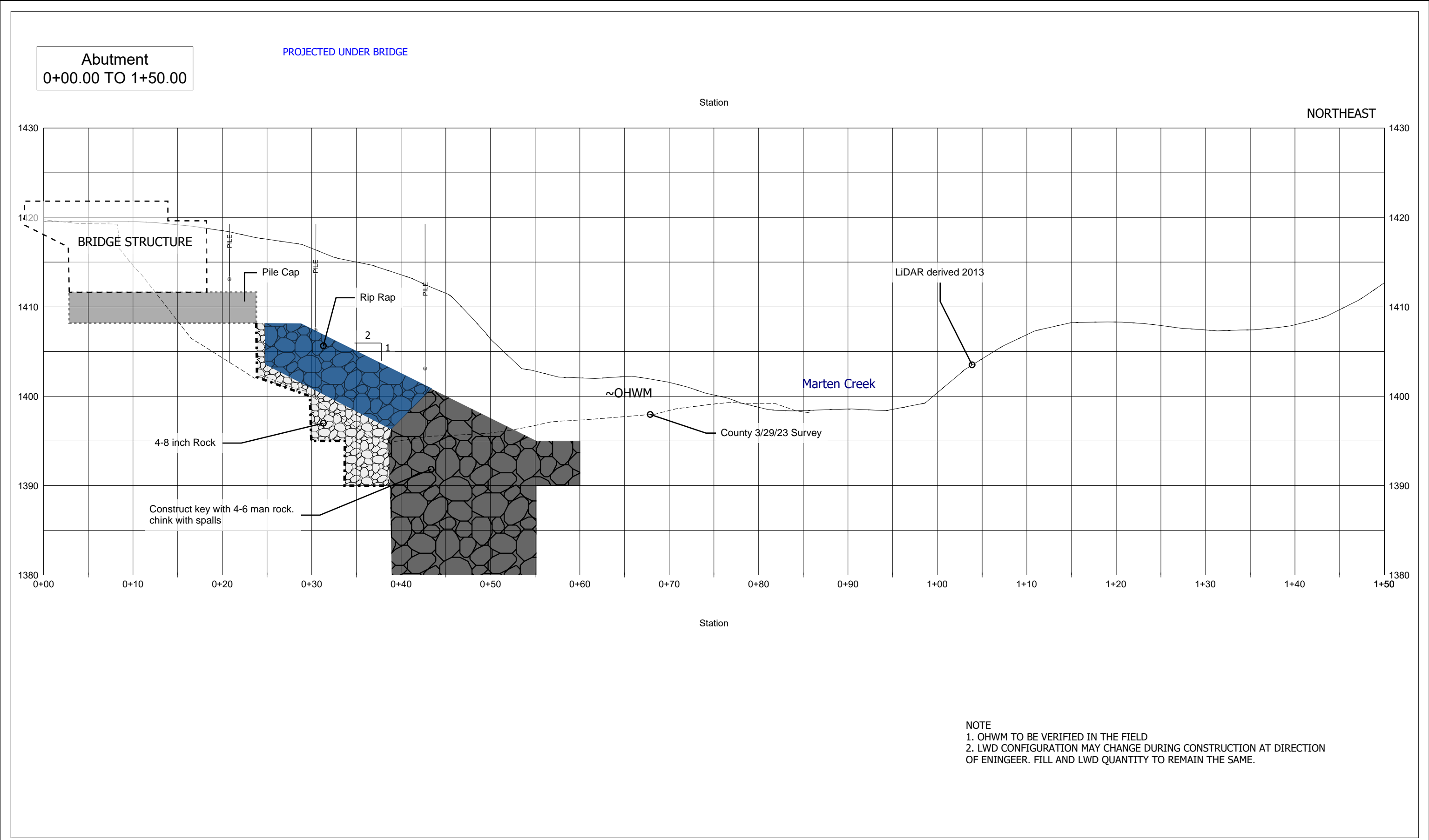

PURPOSE: CONCEPTUAL REPAIR OF FAILING EMBANKMENTS AT CONFLUENCE OF MARTEN CREEK AND THE SOUTH FORK OF STILLAGUAMISH RIVER.
DATUM: NAD83 AND NAVD88
LOCATION: MP 20.6 MLH

OWNER: U.S. FOREST SERVICE
LAT: 48.071841° LONG: -121.606627°

NWS-2023-941-WRD
MOUNTAIN LOOP HIGHWAY MP 20.6
EMERGENCY REPAIR UNDER
BRIDGE SECTION

APPLICATION BY: SNOHOMISH COUNTY PUBLIC WORKS
STATE: WASHINGTON
DATE: DECEMBER 13, 2023

SHEET
6
OF
6